

1. Door Fabrication

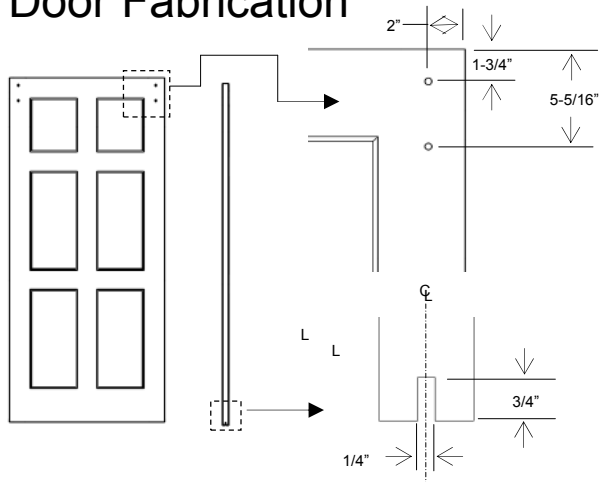

- A. Drill four (4) 3/8" holes at the top of the door. Two on each side as indicated.
- B. Cut a slot down the center of the door as indicated.

2. Door Assembly

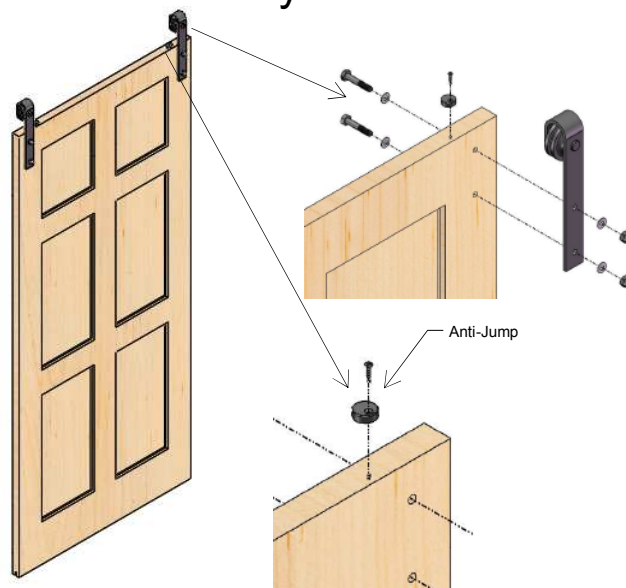

- A. Assemble the rollers as shown.
- B. Drill two (2) 3/32" pilot holes approximately 1/2" deep, 5/16" from the front of the door and 4" in from each side and attach the anti-jumps as shown.

3. Track Installation

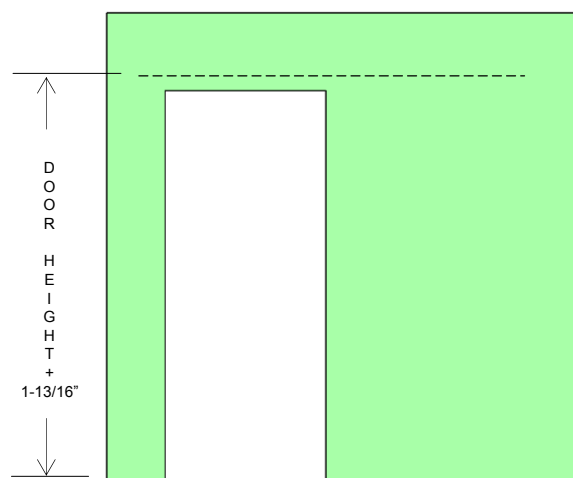

- A. Measure from the finished floor the door height plus 1-13/16" and draw a line. (Example: Door height 80" + 1-13/16" = 81-13/16").

4. Track Installation (Cont.)

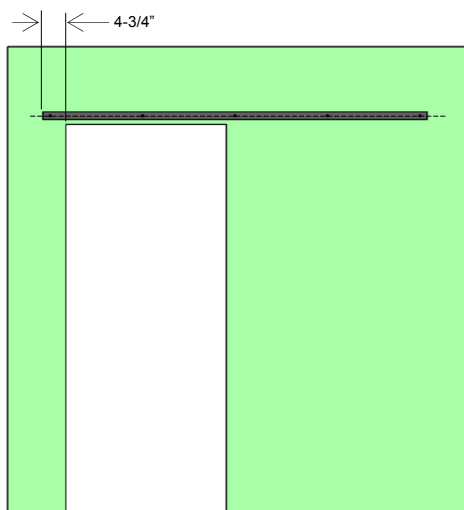

- A. Place the track on the line as shown and transfer the hole locations from the track to the wall.
- B. The holes are to be centered on the line and in some cases, due to blocking, wall anchors may be required.

5. Track Installation (Cont.)

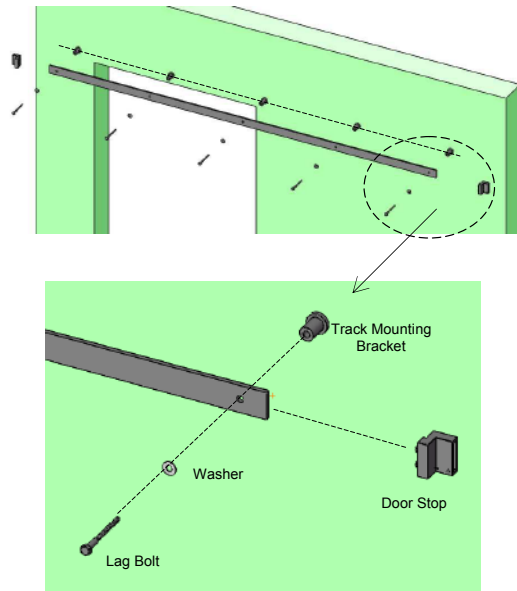

A. Install the track as shown.

6. Bottom Door Guide Installation

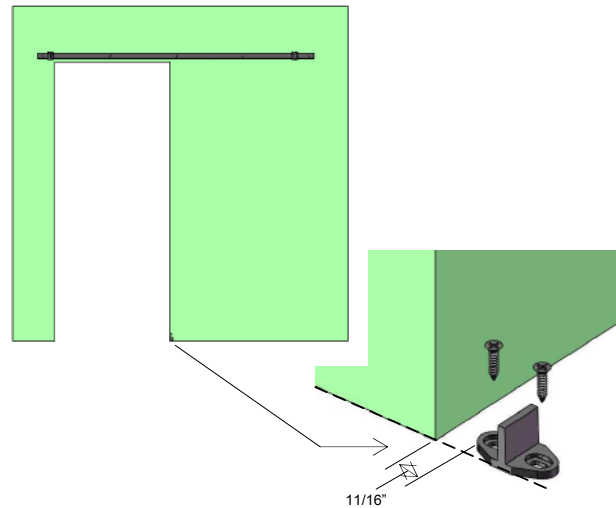

A. Install the bottom door guide as shown.

7. Door Installation

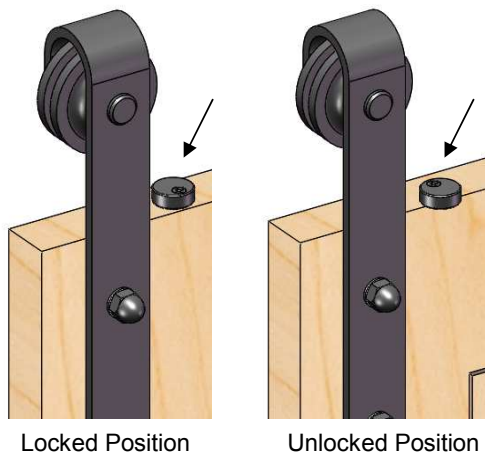

A. Rotate the anti-jump feature as shown. This disengages the anti-jump and allows the rollers to engage the track.

8. Door Installation (Cont.)

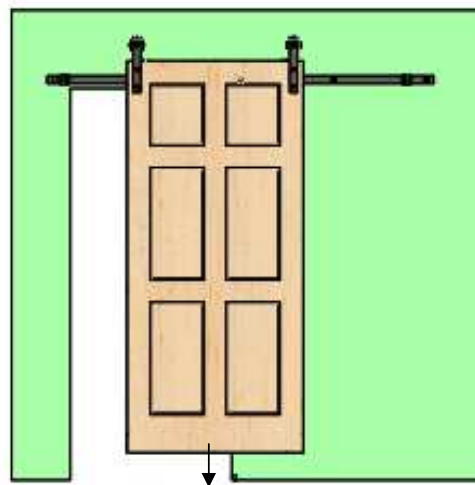

- A. Position the door over the bottom floor guide and slowly lower the door into place.
- B. Engage the rollers with the track and adjust the anti-jumps to the locked position.
- C. Adjust the door stops as needed.