

FRONT VIEW TOP ROLLER

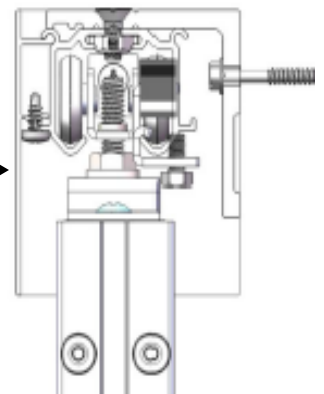

SIDE VIEW TOP ROLLER

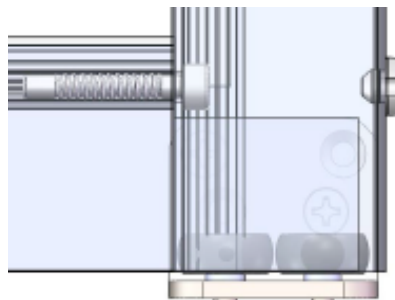

FRONT VIEW BOTTOM ROLLER

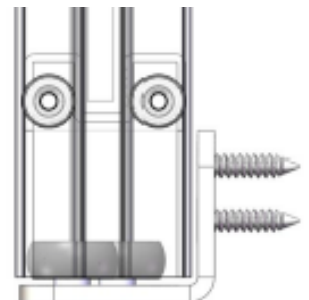

SIDE VIEW BOTTOM ROLLER

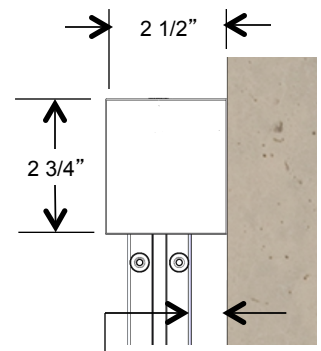
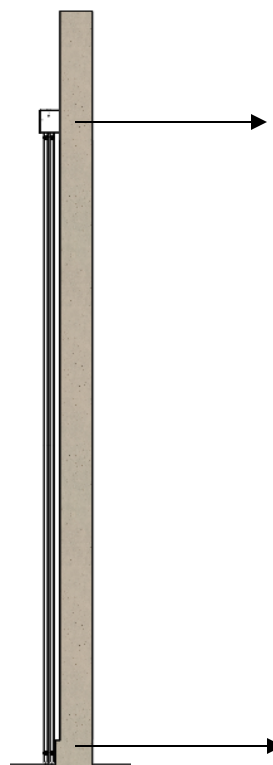
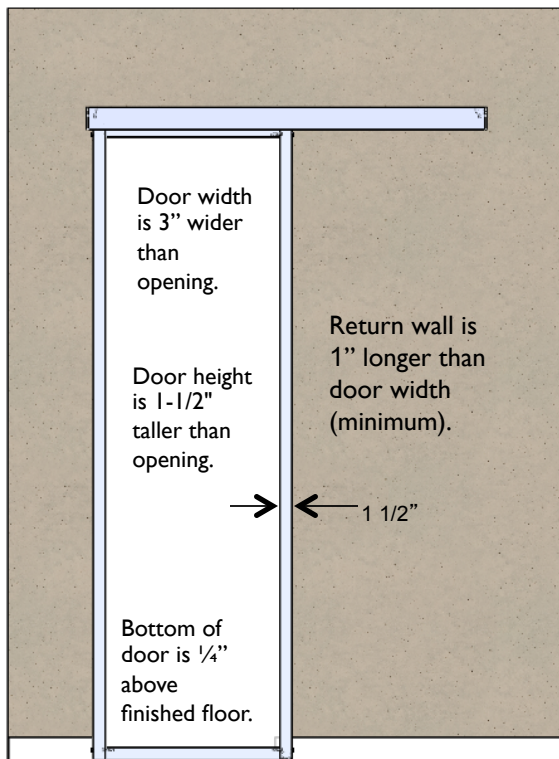

There are three settings:

9/16" for 1/4" to 3/8" base boards
3/4" for 1/2" to 5/8" base boards *
1" for 3/4" to 7/8" base boards

* Is standard.

1 5/16"

